

# Meridian Archer Trailer Kit 1000



## Meridian Archer Trailer Kit 1000

- 8- Archer 1200 Barriers
- 1-Archer Hauler 2.0
- 2- Archer Field Tow Bars
- 7- 4ft. Archer Arrestor Cables
- 1- Archer Rapid Gate Kit
- 1- Archer Wayfinding Package
- 7- ADA 3-Channel Cable Covers
- 1-Archer Hauler Mount
- 2-ADA Cover Compartments
- Beam Gate Beam Cradles

## NEW Rapid Gate Kit



## NEW Wayfinding Package

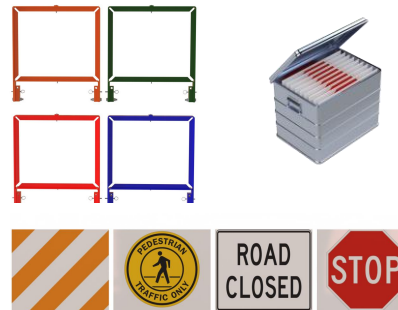

## NEW Hauler Mount



## NEW ADA Cover Compartments



## NEW Beam Gate Beam Cradles



## Additional Upgrades

- Upgraded solar panel charger
- Upgraded deck bearings
- Higher rated tires



**MERIDIAN**  
RAPID DEFENSE GROUP



# Meridian Archer Trailer Kit 1000 Components

**8-** Archer 1200 Barrier



**1-** Archer Hauler 2.0



**2-** Archer Field Tow Bar



**7-** 4ft. Archer Arrestor Cable



**1-** Archer Rapid Gate Kit



**1-** Archer Wayfinding Package

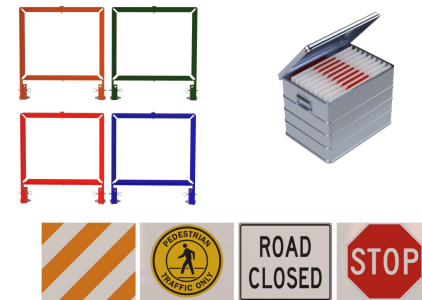

**7-** ADA 3-Channel Cable



**1-** Archer Hauler



**2-** ADA Storage Compartment



**1-** Beam Gate Beam Cradle



# Archer 1200 Barrier Specifications



## Archer 1200 Barrier Specifications

- Length- 48 in.
- Width- 24 in.
- Height- 57 in.
- Weight- 680 lbs.
- Surface Area- 11,288 square in.
- Material- ASTM A36 steel/AR500

## Powder coat Specifications

- Gloss 60° angle (ASTM D-523-89) 80+
- Hardness (ASTM D-3363-92A) H – 2H
- Flexibility (ASTM D-1737-89) 1/8 inch
- Adhesion (ASTM D-3359-95A) 5B
- Impact direct/indirect (ASTM D-2794-93) 120 in-lbs.
- Salt Spray (ASTM B117) 1000 Hrs.

## Caster Wheel Specifications

- Type- Black soft rubber tread, crowned profile
- Core Material- Aluminum core
- Wheel Diameter- 10 in.
- Wheel Width- 2.25 in.
- Capacity- 400 lbs.

# Archer Hauler Specifications



**Lift 700 lbs. of steel with ease**

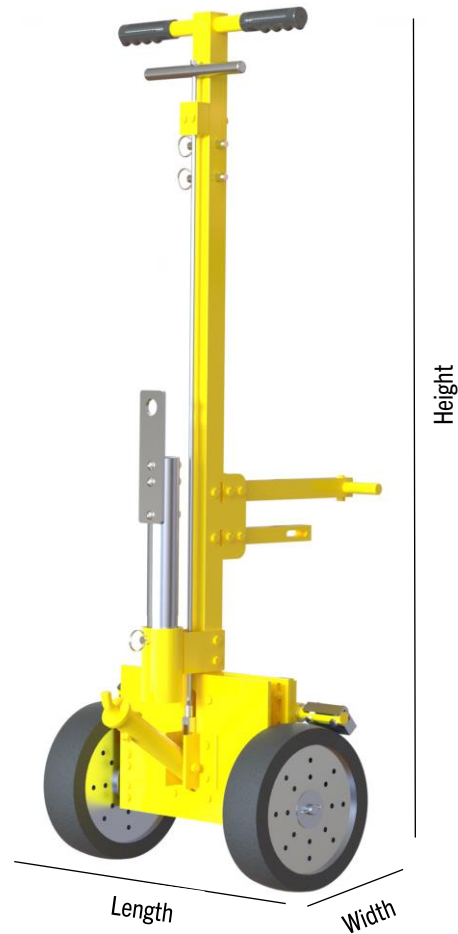

**Simple storage on Archer 1200 Barriers**

**Scan for more information**

## Archer Hauler Dimensions

- Length- 18 in.
- Width- 12 in.
- Height- 53 in.
- Weight- 40 lbs.
- Material- Aluminum 6061-T6

## Archer Hauler Features

- Adjustable brakes
- 3,000 lb. capacity
- Solid core tire
- Durable powder coating



# Archer Tow Bar Specifications



## Unique storage on Archer 1200 Barriers

### Specifications

- Length- 48 in.
- Width- 16 in.
- Depth - 2 in.
- Weight- 20 lbs.
- Material- ASTM A36 steel

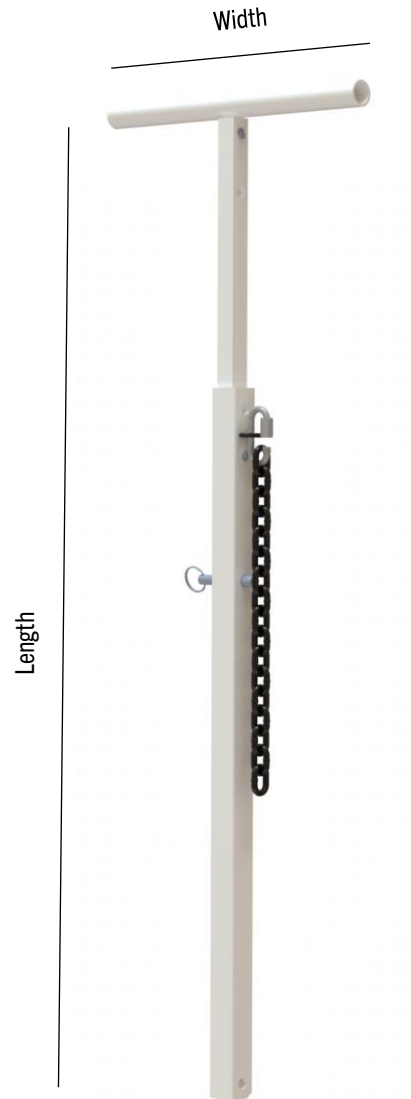

## Easily provide emergency access by moving one Archer 1200 Barrier

### Features

- Emergency access alternative
- Easy storage
- Durable powder coating

# Archer Arrestor Cable Specifications



## Arrestor Cable Specifications

- Length- 48 in.
- Width- 4 in.
- Depth - 2 in.
- Weight- 11 lbs.

## Wire Rope Cable Specifications

- Construction- 6x19 IWRC
- Nominal Diameter-0.625 in & 0.375 in.
- Finish- Galvanized
- Lay Direction- RHRL
- Specification- ASTM A 1023 or RR-W410G
- Grade of Steel Used- EIPS
- Min. Breaking Strength- 24,004 lbs.

## Wire Rope Cable Chemical Composition

- C: 0.69-0.73%
- Si: 0.200.024%
- S: Max 0.025%
- P: Max 0.025%
- Mn: 0.54-0.64%
- P: Max 0.025%
- Mn: 0.54-0.64%

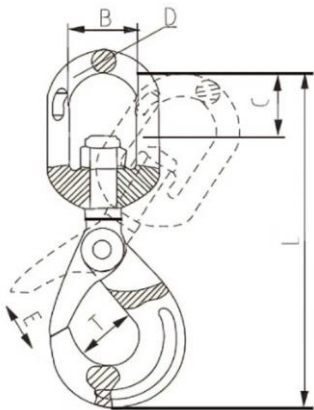

## G-100 Swivel Hook Specifications

- Weight- 2.6 lbs.
- Quenched and tempered alloy steel
- EN 1677-3 & ASME B30.26, PAS1061
- Full swivel under load
- Federal Specification RR-C-271G Type IVA, Grade A, Class 2

## G-100 Specifications Dimensions

- B- 1.42 in.
- C- 1.44 in.
- D- 0.51 in.
- T- 1.35 in.
- L- 7.35 in.
- E- 1.28 in.



# Archer Rapid Gate Kit Specifications

The Archer Rapid Gate can easily be expanded to 10 ft., 12 ft., or 14 ft.

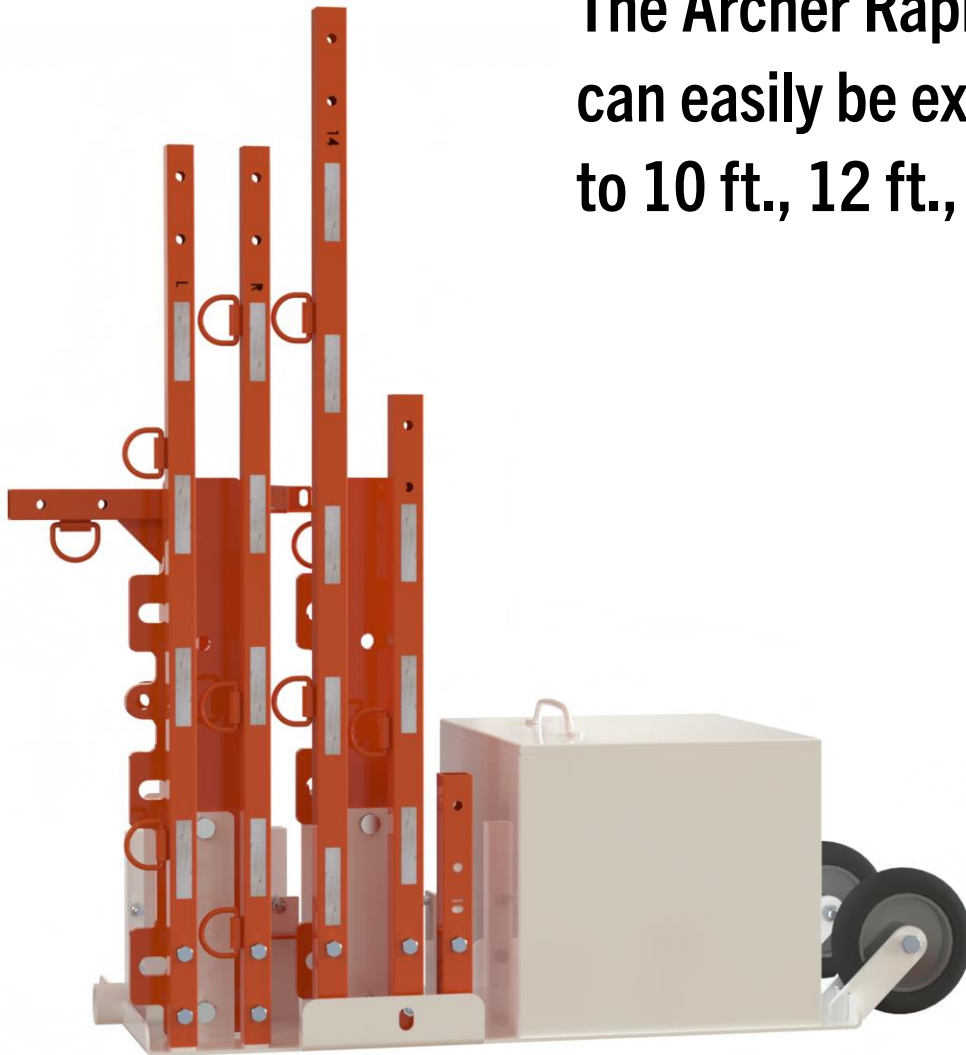

**10 ft.** Beam Connector

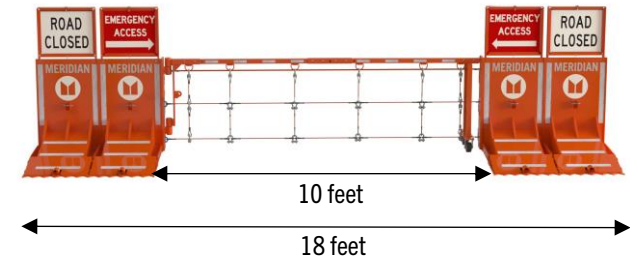

**12 ft.** Beam Connector

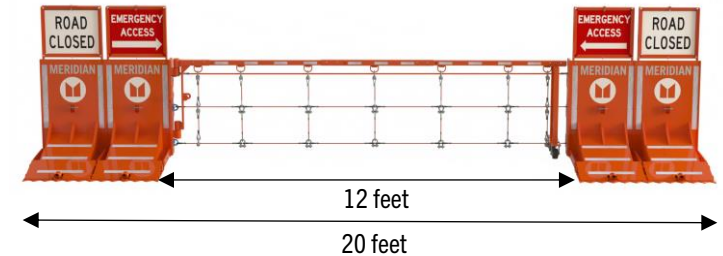

**14 ft.** Beam Connector

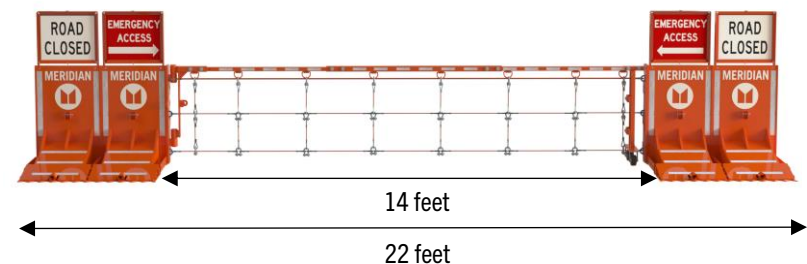

## The Archer Rapid Gate Kit includes the following.

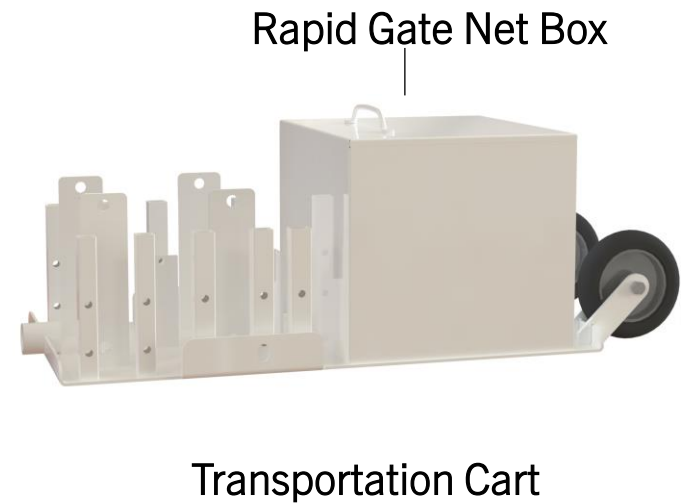
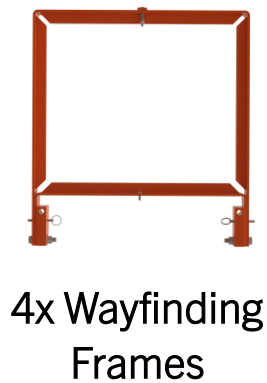
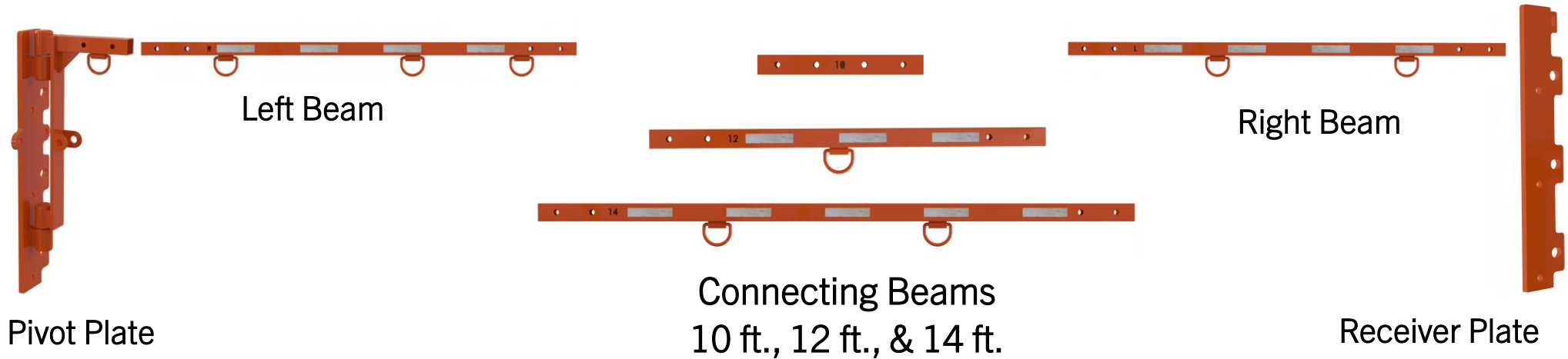



# Archer Rapid Gate Kit Specifications

Component	Length	Width	Height	Weight
Beam L	57.5 in.	1.75 in.	5.0 in.	12.39 lbs.
Beam R	57.5 in.	1.75 in.	5.0 in.	12.9 lbs.
10 ft. Connector	17.0 in.	2.0 in.	2.0 in.	3.81 lbs.
12 ft. Connector	41.7 in.	2.0 in.	5.0 in.	10.0 lbs.
14 ft. Connector	66.5 in.	2.0 in.	5.0 in.	16.2 lbs.
Pivot Plate	36.30 in.	9.29 in.	14.86 in.	82.0 lbs.
Receiver Plate	36.30 in.	7.37 in.	0.75 in.	46.78 lbs.
Archer Rapid Gate Leg	35.90 in.	16.0 in.	7.66 in.	21.60 lbs.
Wayfinding Frame	24.21 in.	22.29 in.	2.25 in.	7.61 lbs.
Wayfinding Insert	21.40 in.	0.16 in.	18.0 in.	0.3 lbs.

Component	Length	Width	Height	Weight	Capacity
Transportation Cart	58.0 in.	24.0 in.	38.0 in.	198 lbs.	
Wayfinding Box	23.45 in.	20.8 in.	38.0 in.		7.14 cubic feet
Archer Rapid Gate Net Box	20.8 in.	7.0 in.	38.0 in.		38 marketing inserts

Archer Rapid Gate Kit	Total Weight – 498 lbs.
Archer Rapid Gate Total Width at 10 ft. openings	18 feet
Archer Rapid Gate Total Width at 12 ft. openings	20 feet
Archer Rapid Gate Total Width at 14 ft. openings	22 feet

**Installation  
Manual**



# Archer Wayfinding Package Specifications

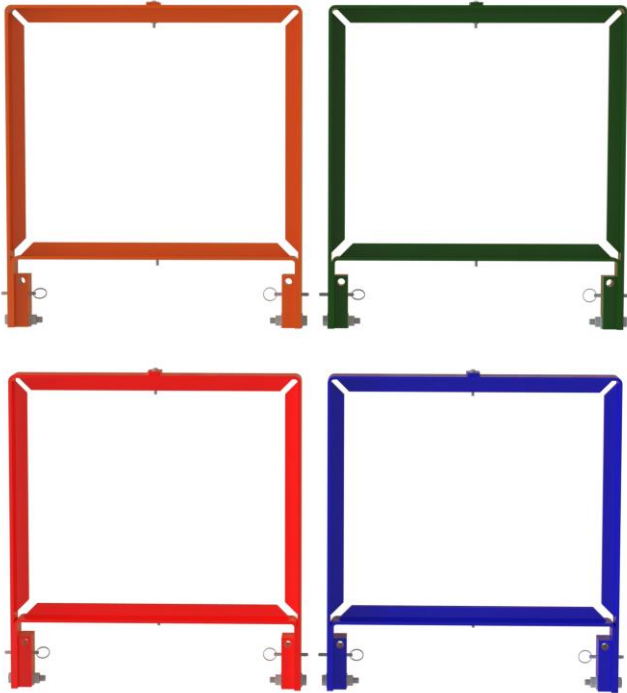

## 8 – Wayfinding Frames

### Archer Wayfinding Frame Dimensions

- Length- 24.25 in.
- Width- 22.25 in.
- Depth - 2 in.
- Weight- 9 lbs.
- Custom colors



## 32 - Wayfinding Signs

- 8- Directional caution signs
- 8- Pedestrian traffic only signs
- 8- Road closed signs
- 8- Stop signs

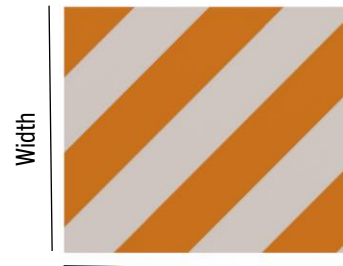

### Wayfinding Sign Dimensions

- Length- 21.35 in.
- Width- 18.25 in.
- Depth - 0.16 in.
- 32 Wayfinding Signs

# ADA 3-Channel Cable Protector Specifications

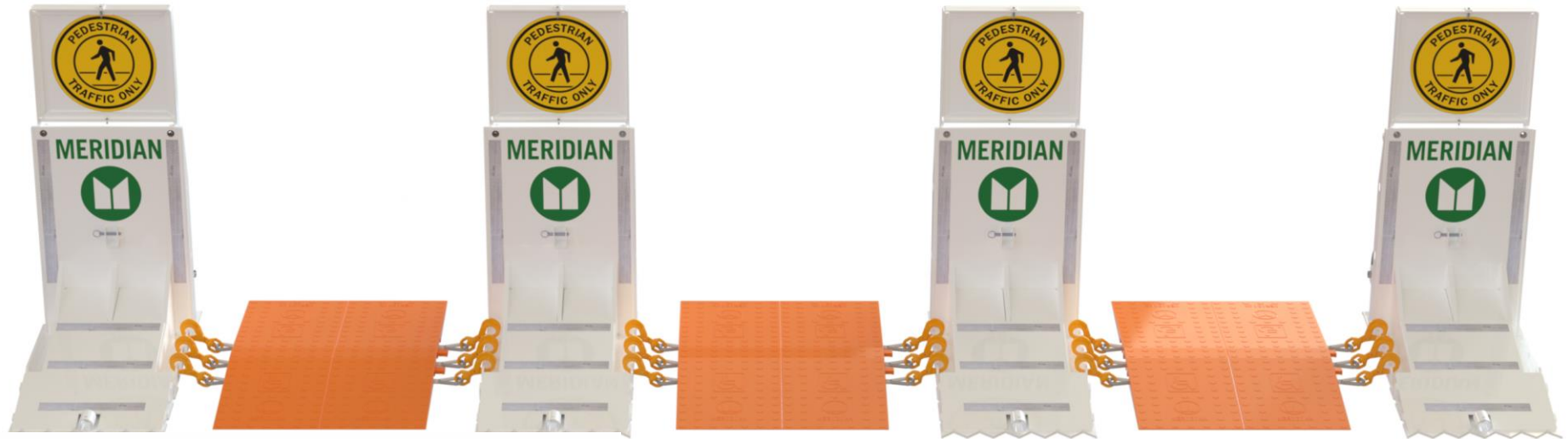

## ADA 3- Channel Dimensions

- Length- 48.0 in.
- Width- 32.25 in.
- Height- 1.5 in.
- Weight- 20 lbs.
- 4.5-degree incline

## ADA 3- Channel Cable Protector

- Easily allows strollers and wheelchairs
- High visibility color
- Ideal for pedestrian traffic control
- Easy to use interconnects
- Lightweight design

# Meridian Archer Trailer Kit 1000 Specifications



Length

Height



Width

## Archer Trailer 1000 Specifications

- Large deck-75-inch deck width
- Capacity 9,995 lbs.
- Deck length- 16 ft.
- Overall length- 21 ft.
- Height- 57 in.
- Wheel size- 16 in.
- Trailer weight empty-3,517 lbs.
- Tongue weight empty- 445 lbs.
- Trailer weight fully loaded-9844 lbs.
- Tongue weight fully loaded- 1,430 lbs.
- Hitch ball size- 2-5/16 in.

## Archer Trailer 1000 Features

- Quadra spring suspension for smoother transport
- Low angle ramp for low clearance loading
- Lockable storage compartments-protects components
- Fender less- no protruding fenders
- Automatic deck latch-deck automatically locks
- Tailgate-full width swinging tailgate

# Meridian Archer Trailer Kit 1000

